

Perth 2 Housing Development Sewage Treatment Plant, Jamaica

ETA is currently involved in the detailed design, supply of all treatment equipment and construction of the wastewater treatment facility for National Housing Trust of Jamaica.

Along with our client, ETA is implementing a new sewage treatment plant for the new subdivision in Manchester Parish, Jamaica. The Perth 2 Housing Development will consist of approximately 1,524 new units. Based on the requirements the average flow capacity was calculated at 1,407 m³/day (including allowances for commercial developments).

The treatment process selected for this new sewage treatment facility is the Membrane Aerated Biofilm Reactor (MABR) developed by Fluence. It provides enhanced treatment and is highly efficient using only 15% of energy of normal plants.

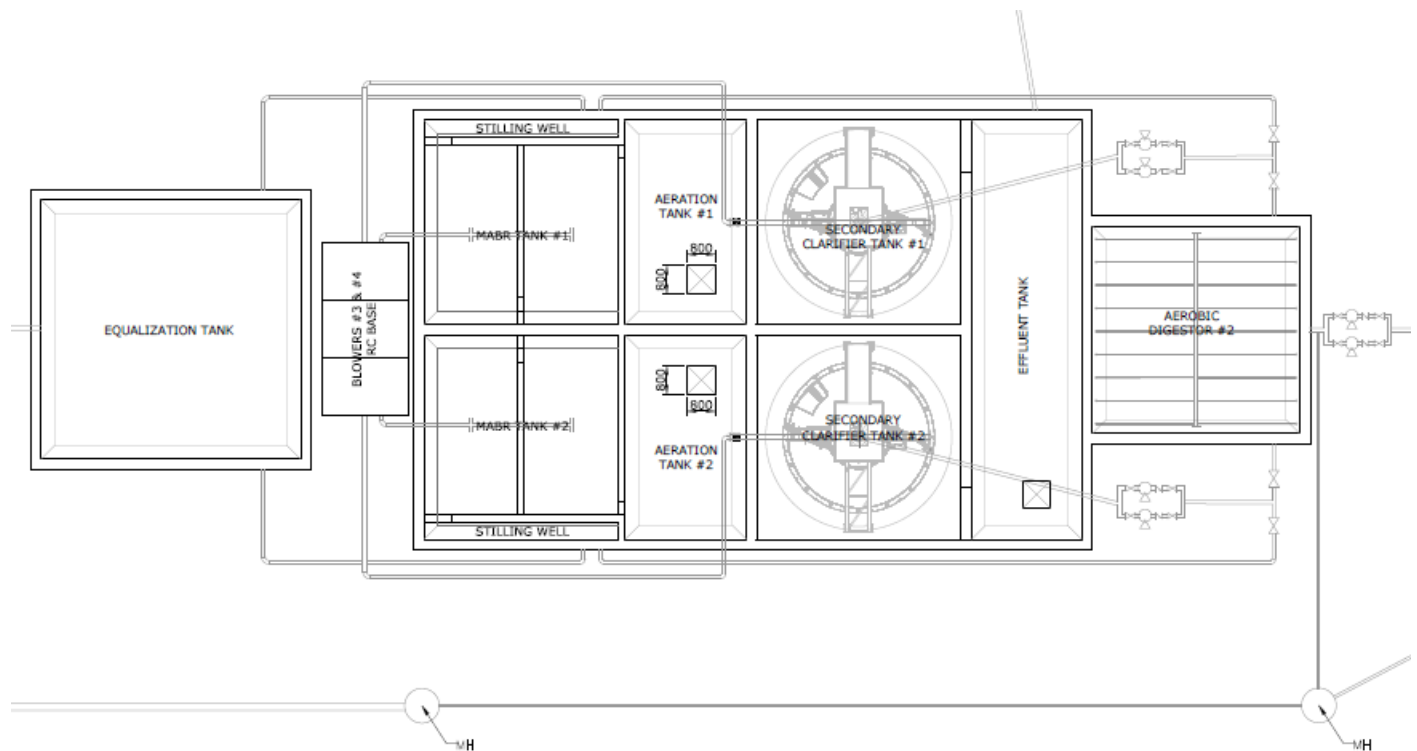

The other treatment units designed and supplied by ETA include the following:

- Influent pumping station
- Coarse screen (5 mm)
- Fine screen (1 mm)
- Submersible mixer in the equalization tank
- SUBRE feed pumps, RAS/WAS pumps, Sludge pumps
- Fine bubble aeration system
- Secondary clarifiers
- UV disinfection system
- Aerobic digester aeration system
- Coarse bubble aeration system

- Automation (instruments and control panels)
- Motor Control Centers
- Valves and actuators

